

NOTE: Arrow on the bottom of this valve always installed facing backwards to incoming air flow.

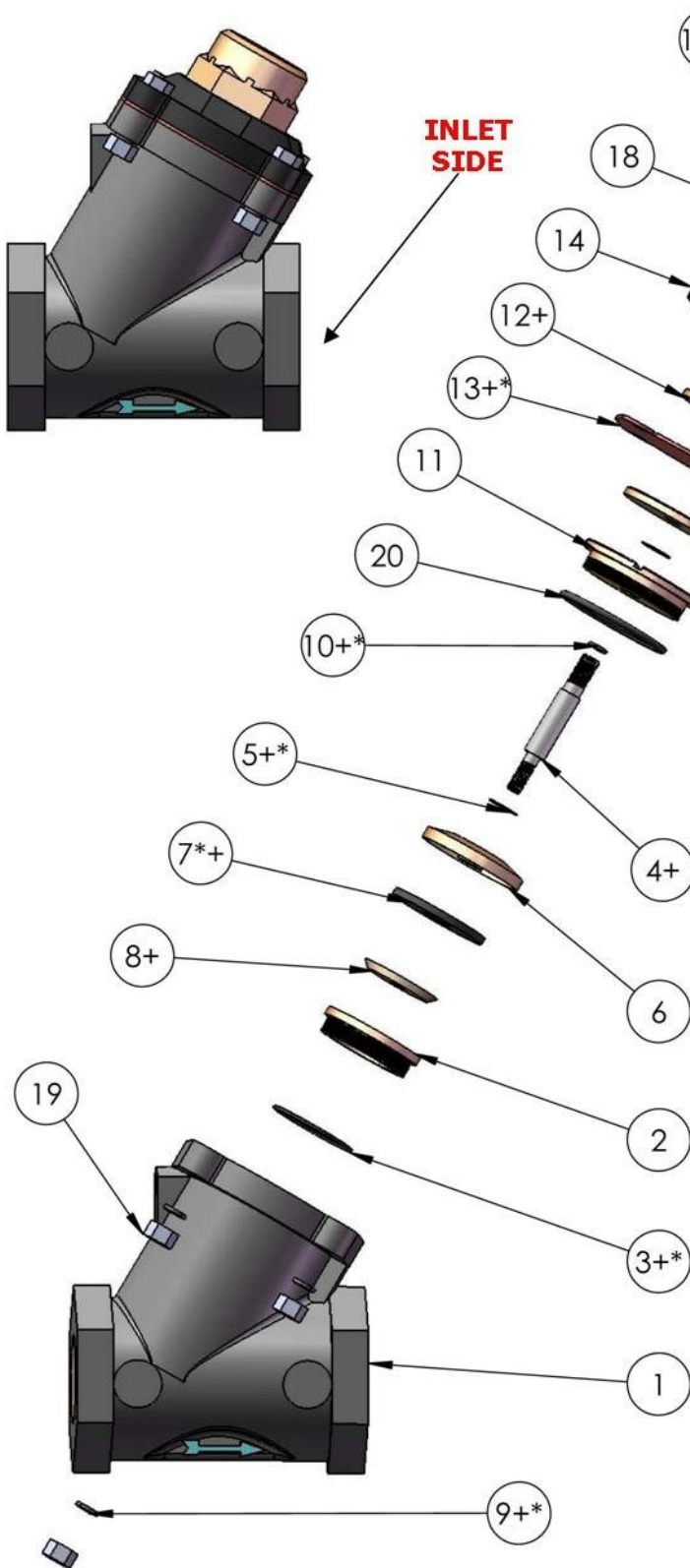

AUTO AIR VALVE

ITEM #	PART # #1.25" & 1.5"	PART # 3/4" & 1"	DESCRIPTION
1			BODY
2	281259		SEAT
3+*			O- RING/THICK
4+			SHAFT
5+*			WASHER/COPPER
6			DISC RETAINER
7+*			RUBBER DISC
8+	281261		DISC PLATE
9+*			LOCK WASHER/1/4"
10+*			O- RING FOR SHAFT
11			RETAINER BUSHING
12+			DIAPHRAGM PLATE
13+*	281256	281006	DIAPHRAGM
14	281258	281007	CAP
15	22123	281005	SPRING
16			SPRING RETAINER
17+*			O- RING/THIN
18	MISC	MISC	BOLT-1/4"
19	MISC	MISC	NUT
20			O RING FOR RETAINER BUSHING
-	281500		AUTO AIR VALVE 1.1/2"
-	281250		AUTO AIR VALVE 1.1/4"
-		280750	AUTO AIR VALVE 3/4"
-		281000	AUTO AIR VALVE 1"

SEAL KIT: * 3/4" & 1" - PART#EE2123-006-99
 1 1/4" & 1 1/2" - PART#EE212300-799
 REPAIR KIT: + 3/4" & 1" - PART#281003
 1 1/4" & 1 1/2" - PART#281253